

# HEB

## Profile late I cu talpi paralele

seria HE-B = I PB

lamine la cald, conf. DIN 1025 sect.2, ed. noiembrie 1995

si EURONORM 53-62

Tolerante dimensionale conf. DIN EN 10034, ed. martie 1994

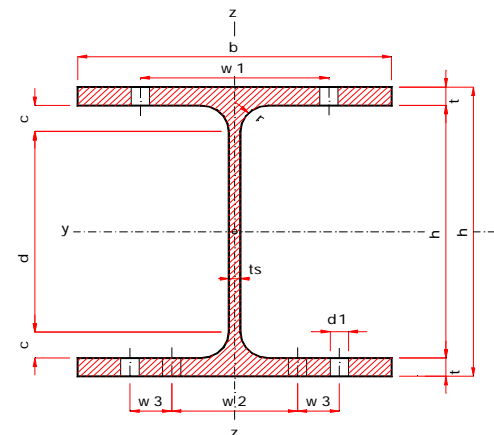

Denumire	Dimensiuni						A	G	Caracteristici sectionale						S <sub>y</sub>	Gaurire conf. DIN 997 ed. oct. 1970				
	Tip	h	b	t <sub>s</sub>	t <sub>g</sub>	r			h-2c	y-y			z-z			d <sub>1</sub>	w <sub>1</sub>	w <sub>2</sub>	w <sub>3</sub>	
										I <sub>y</sub>	W <sub>y</sub>	i <sub>y</sub>	I <sub>z</sub>	W <sub>z</sub>						i <sub>z</sub>
mm							cm <sup>2</sup>	kg/m	cm <sup>4</sup>	cm <sup>3</sup>	cm	cm <sup>4</sup>	cm <sup>3</sup>	cm	mm	mm	mm			
100	100	100	6.0	10.0	12.0	56	26.0	20.4	450	89.9	4.16	167	33.5	2.53	8.63	13	56	-		
120	120	120	6.5	11.0	12.0	74	34.0	26.7	864	144.0	5.04	318	52.9	3.06	10.50	17	66	-		
140	140	140	7.0	12.0	12.0	92	43.0	33.7	1510	216.0	5.93	550	78.5	3.58	12.30	21	76	-		
160	160	160	8.0	13.0	15.0	104	54.3	42.6	2490	311.0	6.78	889	111.0	4.05	14.10	23	86	-		
180	180	180	8.5	14.0	15.0	122	65.3	51.2	3830	426.0	7.66	1360	151.0	4.57	15.90	25	100	-		
200	200	200	9.0	15.0	18.0	134	78.1	61.3	5700	570.0	8.54	2000	200.0	5.07	17.70	25	110	-		
220	220	220	9.5	16.0	18.0	152	91.0	71.5	8090	736.0	9.43	2840	258.0	5.59	19.60	25	120	-		
240	240	240	10.0	17.0	21.0	164	106.0	83.2	11260	938.0	10.30	3920	327.0	6.08	21.40	25	96	35		
260	260	260	10.0	17.5	24.0	177	118.0	93.0	14920	1150.0	11.20	5130	395.0	6.58	23.30	25	106	40		
280	280	280	10.5	18.0	24.0	196	131.0	103.0	19270	1380.0	12.10	6590	471.0	7.09	25.10	25	110	45		
300	300	300	11.0	19.0	27.0	208	149.0	117.0	25170	1680.0	13.00	8560	571.0	7.58	26.90	28	120	45		
320	320	300	11.5	20.5	27.0	225	161.0	127.0	30820	1930.0	13.80	9240	616.0	7.57	28.70	28	120	45		
340	340	300	12.0	21.5	27.0	243	171.0	134.0	36660	2160.0	14.60	9690	646.0	7.53	30.40	28	120	45		
360	360	300	12.5	22.5	27.0	261	181.0	142.0	43190	2400.0	15.50	10140	676.0	7.49	32.20	28	120	45		
400	400	300	13.5	24.0	27.0	298	198.0	155.0	57680	2880.0	17.10	10820	721.0	7.40	35.70	28	120	45		
450	450	300	14.0	26.0	27.0	344	218.0	171.0	79890	3550.0	19.10	11720	781.0	7.33	40.10	28	120	45		
500	500	300	14.5	28.0	27.0	390	239.0	187.0	107200	4290.0	21.20	12620	842.0	7.27	44.50	28	120	45		
550	550	300	15.0	29.0	27.0	438	254.0	199.0	136700	4970.0	23.20	13080	872.0	7.17	48.90	28	120	45		
600	600	300	15.5	30.0	27.0	486	270.0	212.0	171000	5700.0	25.20	13530	902.0	7.08	53.20	28	120	45		
650	650	300	16.0	31.0	27.0	534	286.0	225.0	210600	6480.0	27.10	13980	932.0	6.99	57.50	28	120	45		
700	700	300	17.0	32.0	27.0	582	306.0	241.0	256900	7340.0	29.00	14400	963.0	6.87	61.70	28	126	45		
800	800	300	17.5	33.0	30.0	674	334.0	262.0	359100	8980.0	32.80	14900	994.0	6.68	70.20	28	130	40		
900	900	300	18.5	35.0	30.0	770	371.0	291.0	494100	10980.0	36.50	15820	1050.0	6.53	78.50	28	130	40		
1000	1000	300	19.0	36.0	30.0	868	400.0	314.0	644700	12890.0	40.10	16280	1090.0	6.38	86.80	28	130	40		

## Valori de calcul - Profile HEB

Denumire	$W_{pl,y}$	$M_{pl,y}$	$N_{pl}$	$Q_{pl,z} = V_{pl,z}$	$W_{pl,z}$	$S_y$	$I_T$	$C = I_w$	$i_{z,g}$	Denumire
Tip	cm <sup>3</sup>	kNm	kN	kN	cm <sup>3</sup>	cm <sup>3</sup>	cm <sup>4</sup>	cm <sup>6</sup>	cm	Tip
<b>100</b>	104	25.0	625	74.8	51.4	52.1	9.29	3375	2.63	<b>100</b>
<b>120</b>	165	39.7	816	98.2	81.0	82.6	13.90	9410	3.24	<b>120</b>
<b>140</b>	245	58.9	1031	124.0	120.0	123.0	20.10	22480	3.80	<b>140</b>
<b>160</b>	354	85.0	1302	163.0	170.0	177.0	31.40	47940	4.31	<b>160</b>
<b>180</b>	481	116.0	1566	196.0	231.0	241.0	42.30	93750	4.87	<b>180</b>
<b>200</b>	643	154.0	1874	231.0	306.0	321.0	59.50	171100	5.33	<b>200</b>
<b>220</b>	827	198.0	2185	269.0	394.0	414.0	76.80	295400	5.95	<b>220</b>
<b>240</b>	1053	253.0	2544	309.0	498.0	527.0	103.00	486900	6.47	<b>240</b>
<b>260</b>	1283	308.0	2843	336.0	602.0	641.0	124.00	753700	6.99	<b>260</b>
<b>280</b>	1534	368.0	3153	381.0	718.0	767.0	144.00	1130000	7.54	<b>280</b>
<b>300</b>	1869	448.0	3578	428.0	870.0	934.0	186.00	1688000	8.06	<b>300</b>
<b>320</b>	2149	516.0	3872	477.0	939.0	1075.0	226.00	2069000	8.06	<b>320</b>
<b>340</b>	2408	578.0	4102	530.0	986.0	1204.0	258.00	2454000	8.05	<b>340</b>
<b>360</b>	2683	644.0	4335	585.0	1032.0	1341.0	293.00	2883000	8.03	<b>360</b>
<b>400</b>	3232	776.0	4747	703.0	1104.0	1616.0	357.00	3817000	7.99	<b>400</b>
<b>450</b>	3982	956.0	5231	823.0	1198.0	1991.0	442.00	5258000	7.97	<b>450</b>
<b>500</b>	4815	1155.0	5727	948.0	1292.0	2407.0	540.00	7018000	7.94	<b>500</b>
<b>550</b>	5591	1342.0	6097	1083.0	1341.0	2795.0	602.00	8856000	7.89	<b>550</b>
<b>600</b>	6425	1542.0	6479	1224.0	1391.0	2313.0	669.00	10965000	7.84	<b>600</b>
<b>650</b>	7320	1757.0	6872	1372.0	1441.0	3660.0	741.00	13363000	7.80	<b>650</b>
<b>700</b>	8327	1999.0	7353	1574.0	1495.0	4164.0	833.00	16064000	7.73	<b>700</b>
<b>800</b>	10229	2454.0	8020	1860.0	1553.0	5114.0	949.00	21840000	7.61	<b>800</b>
<b>900</b>	12584	3020.0	8911	2217.0	1658.0	6292.0	1140.00	29461000	7.52	<b>900</b>
<b>1000</b>	14855	3565.0	9601	2538.0	1716.0	7428.0	1260.00	37637000	7.43	<b>1000</b>

### Nota

Setul de date a fost colationat cu cea mai mare atentie. Pentru eventuale erori de redactare nu preluam nici o raspundere.

Sursa: Stahlbau-Profile, ed. a 22-a, Verlag Stahleisen GmbH, 1999

**DeltaMETALS®**

a division of DeltaTHERM TRADING s.r.l.

e-mail: [deltametals@fx.ro](mailto:deltametals@fx.ro)